

Fast Track Guide

Nikon

COOLPIX 990

This *Fast Track Guide* takes you through the steps involved in setting up your camera and using it in "A-REC," an automatic, point-and-shoot mode designed to produce the best results in most circumstances. For more complete information, refer to the *Guide to Digital Photography*. Cross-references to other documentation are marked by the following symbols:

Guide to Digital Photography (page numbers refer to the print edition)

For Your Safety

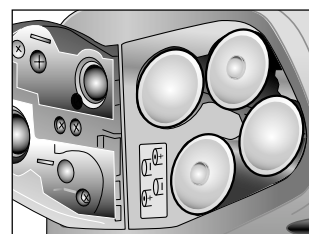

1 Insert the batteries

Before inserting or removing batteries, turn the camera off.

The battery chamber is in the bottom of the camera handgrip. To open, unlatch the cover and flip it open. Insert four AA (LR6) batteries as shown inside the cover. Close the cover and, pressing the label "▼Push" to keep the cover firmly closed, return the latch to the locked position.

"First Steps: Putting Batteries in the Camera" (pg. 9)

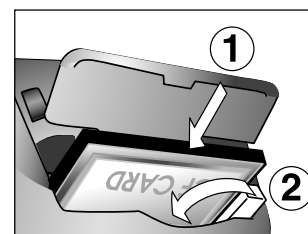

2 Insert the memory card

Before inserting or removing the memory card, turn the camera off.

Open the card-slot cover and slide the memory card in as shown above (1). Fold the eject button over (2) before closing the card-slot cover.

"First Steps: Inserting the Memory Card" (pg. 11)



3 Select A-REC

Turn the mode dial to A-REC. Check that the control panel on top of the camera is on and that the battery indicator is not flashing.

"First Steps: Taking a Photograph" (pg. 15)

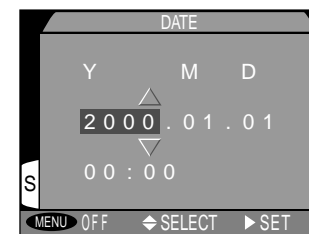

4 Set the time and date

Press the MENU button to display the A-REC menu. Choose **Date** and use the multi selector to set the camera to the current time and date.

"First Steps: Setting the Time and Date" (pg. 13)

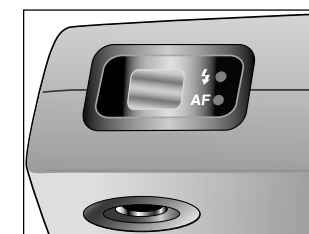

5 Adjust viewfinder diopter

The diopter adjustment dial next to the viewfinder can be used to adjust the finder to suit individual differences in vision.

"First Steps: Getting to Know the COOLPIX 990" (pg. 4)

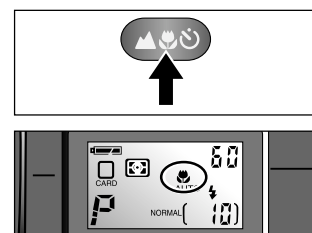

6 Check the focus mode

By default, the camera automatically adjusts focus for subjects 30 cm (1 ft.) or more from the lens. To choose another focus setting, press the button. The following options are available:

Autofocus (default)

Infinity (∞)

Captures distant scenes with maximum clarity. Flash turns off automatically.

"Basic Photography: Focus" (pg. 27)

Macro close-up

Use this mode when taking photos of small objects at close range. At the middle optical zoom position (shown by a yellow in the LCD monitor), you can focus on objects as little as 2 cm (0.8 in.) from the lens.

Self timer

Delays shutter release to prevent camera shake or for self portraits. Press the shutter-release button once for a ten-second delay, twice for a delay of three seconds.

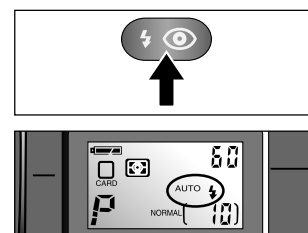

7 Check the flash setting

By default, the flash automatically fires when lighting is poor. To choose another flash setting, press the button. The following options are available:

Auto (default)

Flash fires when needed.

Flash Cancel (off)

"Basic Photography: Using the Flash" (pg. 26)

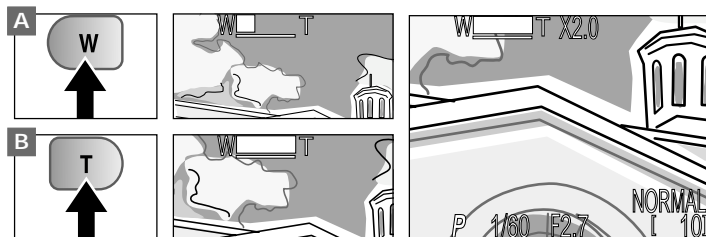

10 Compose a photograph

Use the zoom buttons to frame your subject in the viewfinder or LCD monitor. The button zooms the camera out (A), reducing magnification and increasing the field of view. The button zooms the camera in (B). If the LCD monitor is on or the camera is connected to a television set, you can hold the button down for two seconds at maximum zoom to enter digital zoom mode (C), where you can zoom in a further $\times 4.0$.

"Basic Photography: Optical and Digital Zoom" (pg. 24)

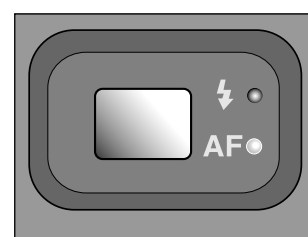

11 Check focus and flash

Gently depress the shutter-release button halfway and check the autofocus and flash indicators next to the viewfinder. The camera is ready to take a picture when the autofocus lamp (green) glows steadily and the flash lamp (red) is not blinking.

12 Take a picture

To take a picture, fully depress the shutter-release button.

"First Steps: Taking a Photograph" (pg. 15)

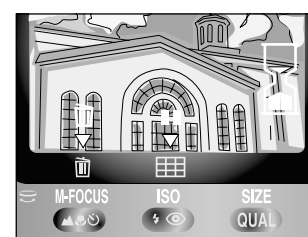

13 Check the results

The picture just taken will be displayed briefly in the LCD monitor while the camera transfers it to memory. Press the button to freeze the display for twenty seconds. If you are not satisfied with the results, press to delete the photo before returning to shooting mode.

"Basic Photography: Reviewing Photographs" (pg. 35)

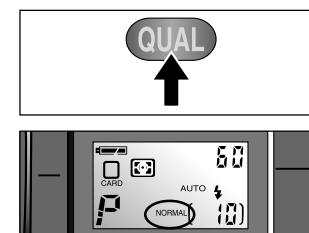

8 Adjust image quality

Together with image size, image quality determines the number of images that can be stored on the memory card. Press the button to choose an image-quality setting from:

NORMAL Default

FINE Fewer pictures, higher quality

BASIC More pictures, basic quality

"Basic Photography: Image Quality and Size" (pg. 31)

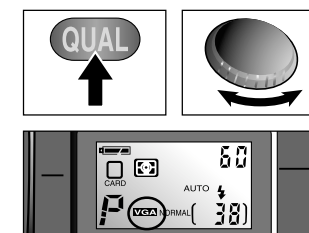

9 Choose an image size

To select an image size, turn the command dial while pressing the button.

Full (2048 \times 1536 pixels)

XGA 1024 \times 768 pixels

VGA 640 \times 480 pixels

3:2 2048 \times 1360 pixels (same proportions as 35 mm film)

"Basic Photography: Image Quality and Size" (pg. 31)

How Many Images Can I Record?

The approximate number of images that can be recorded on an 16 MB memory card at different combinations of image quality and size is shown in the following chart:

	Full	XGA	VGA	3:2
FINE	~10	~40	~100	~11
NORMAL	~20	~79	~187	~23
BASIC	~40	~151	~333	~46

"Basic Photography: Image Quality and Size" (pg. 31)

Parts of the COOLPIX 990

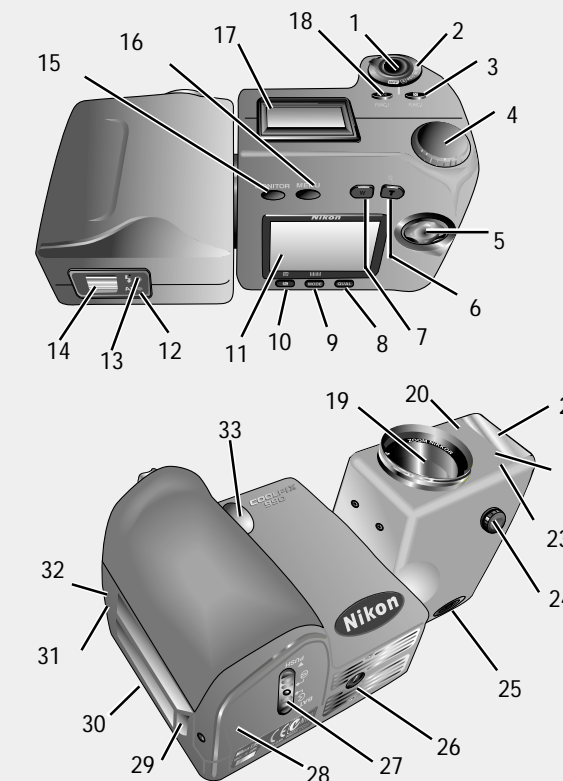

- | | |
|--|---------------------------------|
| 1 Shutter-release button | 16 MENU button |
| 2 Mode dial | 17 Control panel |
| 3 Exposure compensation (FUNC 2) button | 18 MODE (FUNC 1) button |
| 4 Command dial | 19 Lens |
| 5 Multi Selector | 20 Viewfinder |
| 6 Zoom-in () button | 21 Built-in flash |
| 7 Zoom-out () button | 22 Red-eye reduction lamp |
| 8 Image-quality/Size button () | 23 Photocell |
| 9 Flash/Sensitivity (Thumbnail) button () | 24 Connector for external flash |
| 10 Focus mode (Delete) button () | 25 Diopter adjustment dial |
| 11 LCD Monitor | 26 Tripod socket |
| 12 Autofocus lamp | 27 Battery-chamber latch |
| 13 Flash-ready lamp | 28 Battery-chamber cover |
| 14 Viewfinder eyepiece | 29 Eyelet for camera strap |
| 15 MONITOR button | 30 Memory card slot |
| | 31 USB/serial connector |
| | 32 VIDEO OUT |
| | 33 DC-IN connector |

Playback

To play images back, turn the mode dial to PLAY. The most recent image in memory will be displayed in the LCD monitor. The operations that can be performed in single-image playback are summarized in the following chart:

Button	Operation	Function
	Rotate	View additional information on current photo
	Press	View other photographs in memory
	Press	Zoom in on photograph (use multi selector to scroll image)
	Press	Cancel zoom
	Press	Select current photo for deletion
	Press	Start or stop movie playback

"Playback" (pg. 62)